

---

**7616 Qpl Qualified (Qualified Product List)**

---

***GENERAL SPECIFICATIONS***

Gas filling	Ne +Halogen
Cathode material	446 Stainless Steel
Maximum length (inch/mm)	2.50/63.4
Effective length (inch/mm)	1.25/31.75
Maximum diameter (inch/mm)	0.34/8.7
Effective diameter (inch/mm)	0.25/6.4
Connector	Grid Cap
Operating temperature range °C	-40 to +75

***WINDOW SPECIFICATIONS***

Areal density (mg/cm <sup>2</sup> )	1.5 - 2.0
Effective diameter (inch/mm)	0.25/6.4
Material	Mica

***ELECTRICAL SPECIFICATIONS***

Recommended anode resistor (meg ohm)	1
Maximum starting voltage (volts)	710
Recommended operating voltage (volts)	760
Operating voltage range (volts)	750 - 950
Minimum dead time (micro sec)	75
Gamma sensitivity Co60 (cps/mr/hr)	10
Tube capacitance (pf)	3
Weight (grams)	12
Maximum background shielded 50mm Pb + 3mm Al (cpm)	10

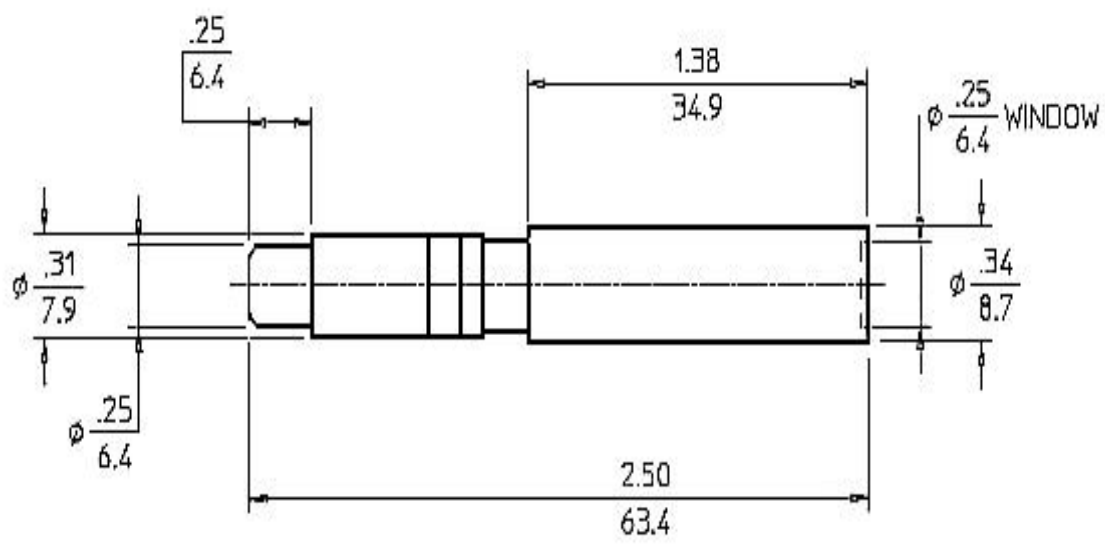

# GAMMA SENSITIVITY

TUBE TYPE - 7616

